

DISASSEMBLY AND ASSEMBLY: FRO...**REMOVAL AND INSTALLATION: AUTOMATIC LOCKING HUBS (WHEEL HUBS AND BEARINGS, FRONT WHEELS, 4-WHEEL DRIVE)**

Section 05-03C: Wheel Hubs and Bearings, Front Wheels, 4-Wheel Drive

1994 Bronco/Econoline/F-Series Workshop Manual

REMOVAL AND INSTALLATION**Automatic Locking Hubs****Removal**

CAUTION: Do not drop spring, ball bearing, bearing race, or retainer.

1. Separate cap from body assembly by removing the five capscrews, using Torx® bit TX25 or equivalent, from the cap.
2. Remove cover.
3. Remove rubber seal.
4. Remove seal bridge retainer (small metal stamping) from retainer ring space.
5. Remove retainer ring by closing the ends with needlenose pliers while pulling hub lock from front disc brake hub and rotor .

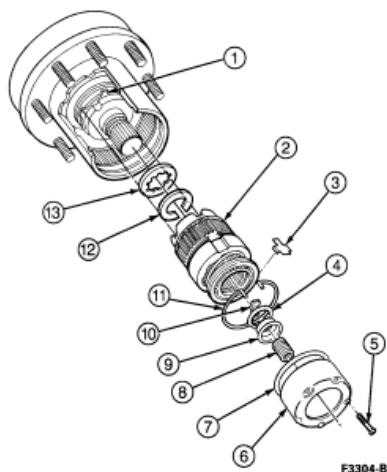

Item	Part Number	Description
1	3B459	Lockwasher
2	1K105	Body
3	1K106	Seal Bridge Retainer
4	1K106	Bearing
5	1K106	Capscrew
6	1K104	Cap
7	1K106	Sealing Ring
8	1K106	Bearing Race Spring
9	1K106	Bearing Inner Race
10	1K106	Spring Retainer
11	1K106	Lock Ring
12	3B457	"C" Washer
13	3B458	Splined Spacer

If front disc brake hub and rotor and front wheel spindle are to be removed:

6. Remove C-washer from stub shaft groove.
7. Remove splined spacer from shaft.
8. Remove wheel bearing locknuts and lockwasher.
9. If the front disc brake **hub** and rotor requires cleaning, refer to Steps 10-16.
10. Wash the cap bearing, race and retainer in cleaner solvent and thoroughly dry the components. Repack the bearing with a lithium base grease, Premium Long-Life Grease XG-1-C or -K (ESA-M1C75-B) or equivalent. Refer to the illustrations for proper positioning of the bearing on the race.

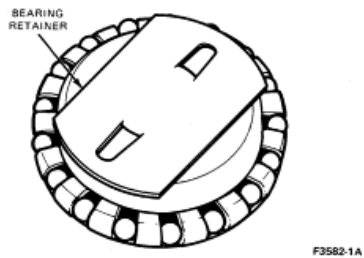
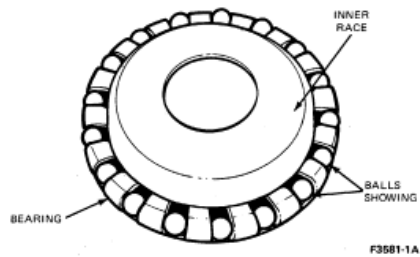

11. Remove the snap ring and flatwasher from the inner end of the **hub** lock assembly.
 12. Pull the **hub** sleeve and attached parts out of the drag sleeve.
- NOTE: Never remove the brake band from the drag sleeve.**
13. Cock the drag sleeve to unlock the tangs of the brake band and remove the drag sleeve assembly.
 14. Wash in cleaner solvent and air dry the drag sleeve and brake band. Lubricate the brake band and drag sleeve assembly with 1.5 grams (0.05 oz.) of Automatic Hublock Grease E1TZ-19590-A (ESL-M1C193-A) (Darmex Spec. DX-123-LT) or equivalent. Work the lubricant over the spring and the area of the drag sleeve under the spring.

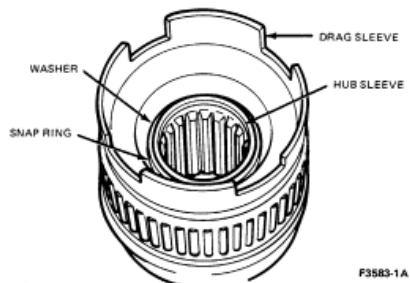

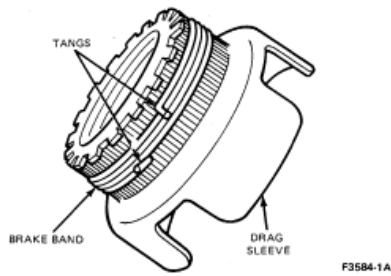

15. The body assembly (excludes cap assembly, and brake band and drag sleeve assembly) should be dipped in Motorcraft MERCON® Multi-Purpose Automatic Transmission Fluid XT-2-QDX (ESP-M2C166-H or ESP-M2C138-C) or equivalent and permitted to drip dry for a few minutes before proceeding with assembly.
16. Assemble one of the two tangs of the brake band on each side of the plastic outer cage located in the window of the steel inner cage. Cock parts to engage the tangs into position as the drag sleeve is positioned against the face of the cam follower. Install the washer and snap ring.

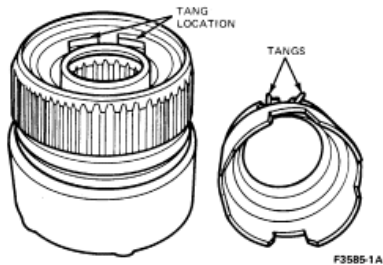

Installation

1. Adjust wheel bearings. Refer to [Adjustments](#) in this section for procedure.
- NOTE: Remove excessive grease from hub lock and hub splines prior to installation.**
2. Install the splined spacer and the C-washer on the halfshaft .
 3. Start hub lock into front disc brake hub and rotor , making sure the large tangs are lined up with the lockwasher and the outside diameter and inside diameter splines are in line with the front disc brake hub and rotor and splines of the halfshaft .
 4. Install retainer ring by closing the ends with needle nose pliers, at the same time, push hub lock into the front disc brake hub and rotor .
 5. Install seal bridge retainer (small metal stamping) with narrow end first.
 6. Install rubber seal over hub lock.
 7. Install cover (make sure ball bearing, spring, bearing race and retainer are in place).
 8. Tighten the 5 screws to 4.5-5.6 Nm (40-50 in-lb) using Torx® Bit TX25 or equivalent in following sequence: tighten one, skip one, etc.

This publication contains material that is reproduced and distributed under a license from Ford Motor Company. No further reproduction or distribution of the Ford Motor Company material is allowed without the express written permission of Ford Motor Company.

Copyright 2007 - 2013 Service Repair Solutions, Inc.